

C281M/090060

Steel Recessed Access Cover, 900mm x 600mm clear opening, 80mm tray depth, 85mm frame depth, Loading code M



| CLEAR OPENING (MM) | OVERALL TOP OF FRAME (MM) | FRAME DEPTH (MM) | LOAD DUTY |
|-----------------------|------------------------------|---------------------|---------------------|
| 900 x 600 | 940 x 640 | 85 | Light / medium duty |

KEY FEATURES

- ✓ Hot dipped galvanised for corrosion resistance.
- ✓ Keyway lifting points are provided on the frame for safe handling.

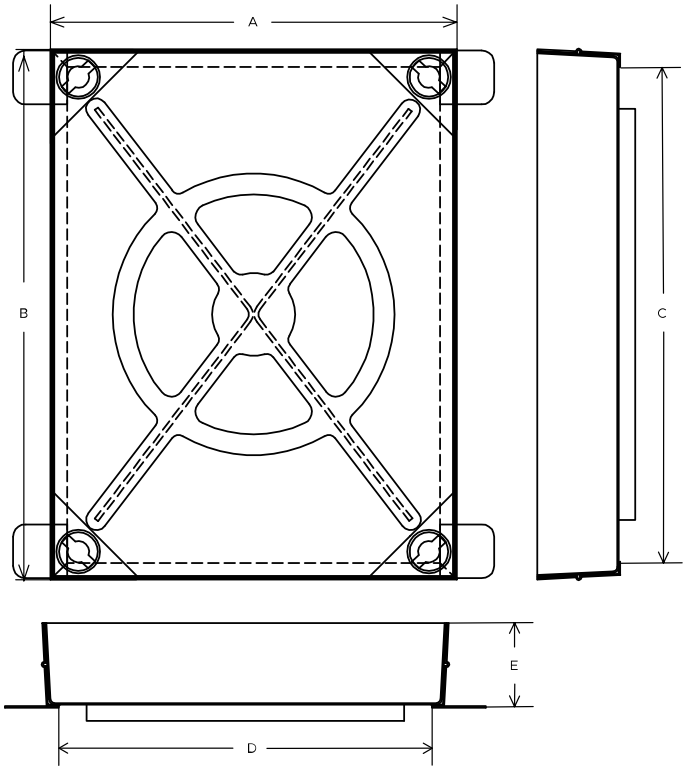

SPECIFICATION

General information

| | |
|--|---------------------|
| Stock code | C281M/090060 |
| Primary material | Steel |
| Category | Access cover |
| Flanges | 4 |
| Gross laden vehicle weight | 10 tn |
| Load duty | Light / medium duty |
| Slow moving wheel load (pneumatic tyres) | 2.5 |

Standards, classes and groupings

| | |
|---------------------|---|
| Wrekin loading code | M |
|---------------------|---|

Dimensions

| | |
|------------------------------|-----------------|
| Frame shape | Rectangular |
| Overall top of frame (A x B) | 640 mm x 940 mm |
| Clear opening (C x D) | 900 mm x 600 mm |
| Frame depth (E) | 85mm |
| Base opening (F x G) | |
| Overall base of frame | 740 mm x 940 mm |

ACCESSORIES

| STOCK CODE | DESCRIPTION |
|------------|--|
| KEYSHEAVY | Large cover lifting keys with a standard handle (sold as a pair) |

NOTES

Mild steel - Hot dip galvanised to BS EN ISO 1461

Lifting keys - Standard heavy-duty key (product code KEYSHEAVY)

1. Wrekin Products Ltd is continually seeking to improve our products and therefore reserves the right to alter product specifications without prior notice.
2. It is the responsibility of all users to satisfy themselves the above data is current.
3. Installation details are available on request.
4. All Wrekin products are supplied subject to our [Terms and Conditions of Sale](#)

