

Chamber step irons for concrete structures

Polypropylene chamber step irons for fitting into new or existing concrete structures.

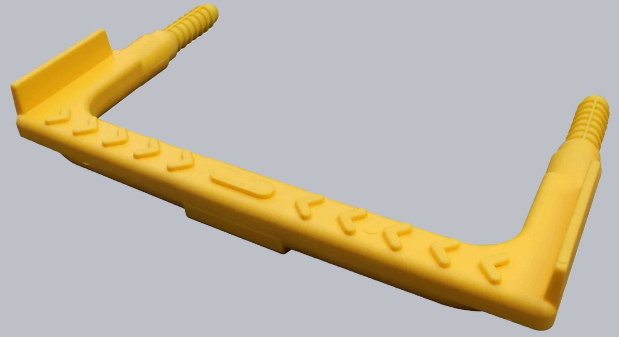

CHARACTERISTIC	VALUE
Description	Polypropylene chamber step irons for fitting into new or existing concrete structures.

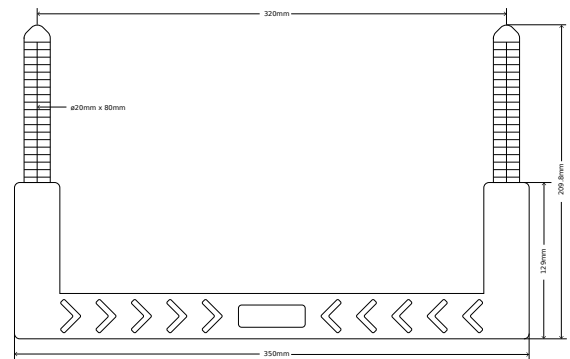

SPECIFICATION

GENERAL INFORMATION

Stock code	STEP/PE/CONCRETE
------------	------------------

DIMENSIONS

Quantity	10
----------	----

BESPOKE STEEL

Step width (B)	350 mm
Step length (C)	129 mm
Insertion depth (D)	80.8 mm

NOTES

Fitting to new or existing structures

- ▶ Drill two 22mm diameter holes, at 320mm centres, at least 90mm deep.
- ▶ Ensure that the holes are parallel and not at right angles to a circular shaft. This is important for double steps to avoid the step being stressed when fitted.
- ▶ Remove dust from hole and apply cementitious or epoxy grout with a compressive strength equivalent to the concrete tails of steps and inside holes.
- ▶ Hammer the step on each leg to drive into holes evenly. Do not hammer the step in the centre as this causes rebound.
- ▶ Make good any spoiling and do not use the step until the grout/epoxy has set or cured.

- ▶ Wrekin Products Ltd is continually seeking to improve our products and therefore reserves the right to alter product specifications without prior notice.
- ▶ It is the responsibility of all users to satisfy themselves the above data is current.
- ▶ All values stated are nominal within 2.5% tolerance.
- ▶ Installation details are available in the [knowledge base](#).
- ▶ All Wrekin products are supplied subject to our [Terms and Conditions of Sale](#).

