

**C281M/067067**

Steel Recessed Access Cover, 675mm x 675mm clear opening, 80mm tray depth, 85mm frame depth, Loading code M

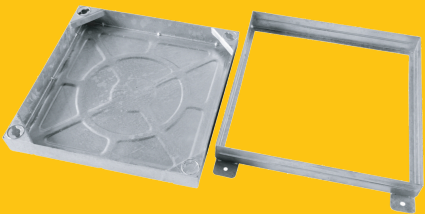

CLEAR OPENING (MM)	OVERALL TOP OF FRAME (MM)	FRAME DEPTH (MM)	LOAD DUTY
675 x 675	715 x 715	85	Light / medium duty

**FEATURES**

- ✓ Hot dipped galvanised for corrosion resistance.
- ✓ Keyway lifting points are provided on the frame for safe handling.

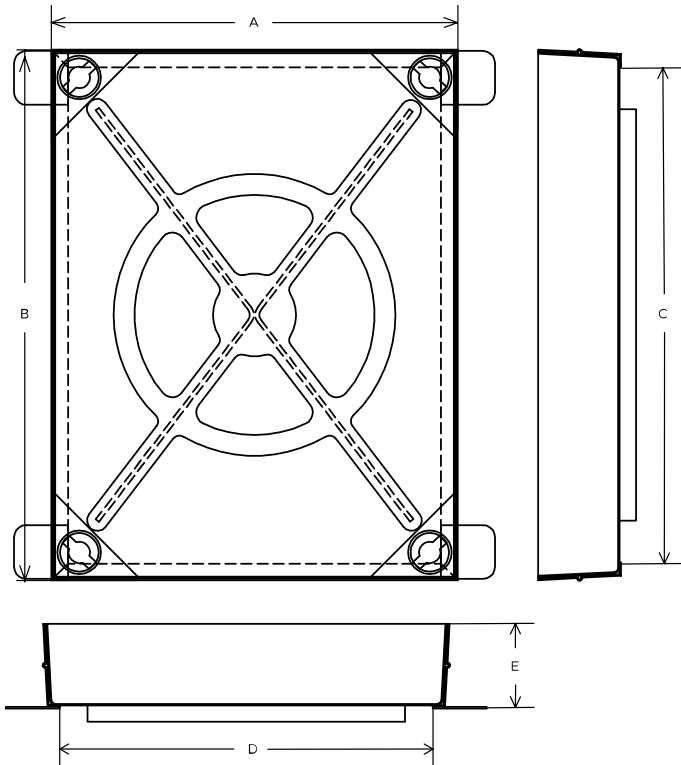

## SPECIFICATION

### General information

Stock code	C281M/067067
Primary material	Steel
Category	Access cover
Flanges	4
Gross laden vehicle weight	10 tn
Load duty	Light / medium duty
Slow moving wheel load (pneumatic tyres)	2.5

### Standards, classes and groupings

Wrekin loading code	M
---------------------	---

### Dimensions

Frame shape	Rectangular
Overall frame (A x B)	
Overall top of frame (A x B)	715 mm x 715 mm
Clear opening (C x D)	675 mm x 675 mm
Frame depth (E)	85mm
Base opening (F x G)	
Overall base of frame	825 mm x 715 mm

## NOTES

Mild steel - Hot dip galvanised to BS EN ISO 1461

Lifting keys - Standard heavy-duty key (product code KEYSHEAVY)

1. Wrekin Products Ltd is continually seeking to improve our products and therefore reserves the right to alter product specifications without prior notice.
2. It is the responsibility of all users to satisfy themselves the above data is current.
3. Installation details are available on request.
4. All Wrekin products are supplied subject to our [Terms and Conditions of Sale](#)

