

## C291M/030030

Steel Recessed Access Cover, 300mm x 300mm clear opening, 100mm tray depth, Loading code M

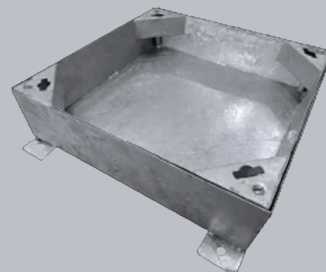

CHARACTERISTIC	VALUE
Clear opening (mm)	300 x 300
Overall top of frame (mm)	340 x 340
Frame depth (mm)	105
Load duty	Light / medium duty

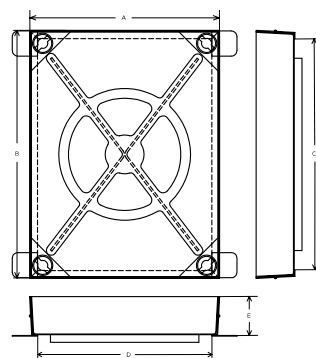

## SPECIFICATION

### GENERAL INFORMATION

Stock code	C291M/030030
Primary material	Steel
Category	Access cover
Flanges	4
Gross laden vehicle weight	10 tn
Load duty	Light / medium duty
Slow moving wheel load (pneumatic tyres)	2.5

### STANDARDS, CLASSES AND GROUPINGS

Wrekin loading code	M
---------------------	---

### DIMENSIONS

Frame shape	Rectangular
Overall top of frame (A x B)	340 mm x 340 mm
Clear opening (C x D)	300 mm x 300 mm
Frame depth (E)	105mm
Overall base of frame	440 mm x 340 mm

## FEATURES

✓ Hot dipped galvanised for corrosion resistance.

✓ Keyway lifting points are provided on the frame for safe handling.

## NOTES

Mild steel - Hot dip galvanised to BS EN ISO 1461

Lifting keys - Standard heavy-duty key (product code KEYSHEAVY)

- ▶ Wrekin Products Ltd is continually seeking to improve our products and therefore reserves the right to alter product specifications without prior notice.
- ▶ It is the responsibility of all users to satisfy themselves the above data is current.
- ▶ All values stated are nominal within 2.5% tolerance.
- ▶ Installation details are available in the [knowledge base](#).
- ▶ All Wrekin products are supplied subject to our [Terms and Conditions of Sale](#).

---

Tel: 01543 440 440  
Fax: 01543 440 444  
[info@wrekinproducts.com](mailto:info@wrekinproducts.com)  
[wrekinproducts.com](http://wrekinproducts.com)

